



WINNEBAGO

**WINNEBAGO**

JOURNEY





The new day dawns.  
A day of unrivaled  
freedom. Connection.  
And life lived to  
its fullest.

Those who will not  
settle know there is  
no rehearsal.

The time for your  
Journey is now.



## Introducing the 2022 Journey®

Our all-new diesel pusher may be the finest motorhome we've ever built. Designed for luxury travel and entertaining, this fully loaded coach features stylish, modern refinements from front to back.

- » Freightliner® XCM chassis with an integrated Maxum™ II foundation
- » 8.9L, 380-hp Cummins® L9 turbo-diesel with torque of 1150 lbs.-ft.
- » Best-in-Class storage featuring SureStore™ compartment doors with push button release and powered cinch close
- » Industry-leading quiet ride with automotive grade sound deadening
- » Winnebago Connect™ smart technology control center with a mobile app
- » Large open living space with premium amenities

**WINNEBAGO**







## Designed for Stylish Entertaining

Simply close off the private bedroom with the sleek sliding wood door, and the Journey's open lounge and kitchen area become the perfect space for an intimate gathering.

The versatile seating and integrated sound system provide stylish ambiance and comfort inside, while the exterior entertainment system, integrated awning and optional refrigerator allow you to extend the party outside when hosting a crowd.





## Revolutionary Design

The tapered front end of the Journey is unlike any other coach on the market, designed to maximize sightlines and reduce noise. The rounded corners, integrated awning, narrow slideout trim, and elimination of cargo door latches further reduce wind resistance while adding to the sophisticated exterior style. This all-new design comes in 34, 36 and 40 foot lengths.

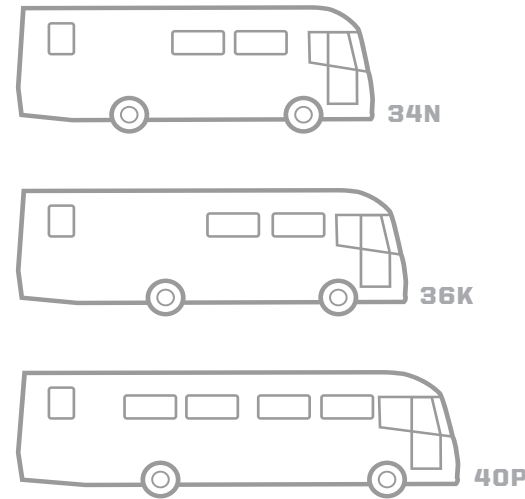

- 1 HIGH-GLOSS SIDEWALLS**  
featuring Sikkens® premium high-gloss enhanced paint in six different finishes for you to choose from
- 2 RECTILINEAR LED HEADLAMPS**  
provide more lighting for a safer driving experience
- 3 BEST-IN-CLASS STORAGE**  
heated, lined and lighted, 31" in height, SureStore™ storage compartments with push-button release, powered, cinching, soft close doors and pass-through slide-out trays accessible from either side of the coach
- 4 POWERED AWNINGS**  
featuring a 22' Carefree® Apex™ awning which expands 12' for covered living space and includes LED lighting and a wind sensor, as well as an additional awning over the door for covered entry into the coach
- 5 SLIDEOUT SWEEPEZE™**  
sweeps any debris off the top of the slideout room when retracted
- 6 EXTERIOR ENTERTAINMENT CENTER**  
with 40" TV, home theater soundbar system (with portable Bluetooth® subwoofer) and available refrigerator/freezer for outdoor entertaining
- 7 EXTERIOR WASH STATION**  
with powered retractable freshwater hose (located on the driver's side) for ease of use
- 8 PET LEASH TIE DOWN**  
to keep your pets safe and close to home





## No Compromises

Frameless, tinted and contoured windows, opposing slideouts, contemporary design and modern finishes make the Journey's open and inviting space perfect for entertaining guests or relaxing in quiet comfort.





## Refined, Spacious Lounge

Versatile seating, convenient technology and ambiance make the Journey's upscale lounge area the pinnacle of RV comfort and function wherever you travel.

- » Rest Easy® sofa or theater seating with lap table for versatility and entertaining
- » 50" Smart HDTV with home theater sound bar system
- » Two innovative and versatile "chottomans" to relax in as chairs or convert to footrests or storage
- » Electric fireplace with ambiance or heat setting
- » Dual-pane, tinted and frameless contoured windows provide a panoramic view
- » Glide & Dine™ table and chairs (34N, 40P) and Dine-O-Workstation™ convertible dining and work space (36K)
- » Central vacuum system handles cleaning with ease
- » Convenient USB chargers and multiplex wall switches throughout



## Modern Kitchen Solutions

The kitchen is the heart of the home, and the fully equipped Journey galley is every bit as attractive and well-designed as the rest of this stunning home on wheels.

- » Modular stainless-steel prep sink, with functional single or dual basin, drying rack and wood cutting board
- » 18-cubic-foot double-door residential refrigerator/freezer with water dispenser, automatic icemaker and bottom freezer drawer
- » Microwave/convection oven with range fan
- » Fast and efficient two-burner Induction range cooktop
- » Corian® countertops with flip-up extension
- » Dual-stacked pantry accessible from either side
- » Available dishwasher

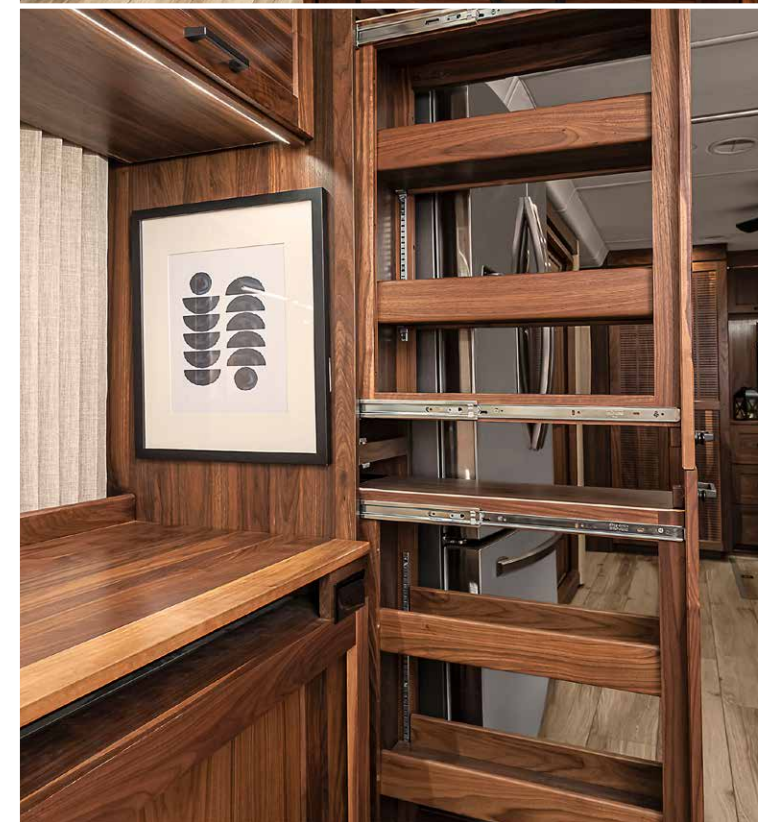
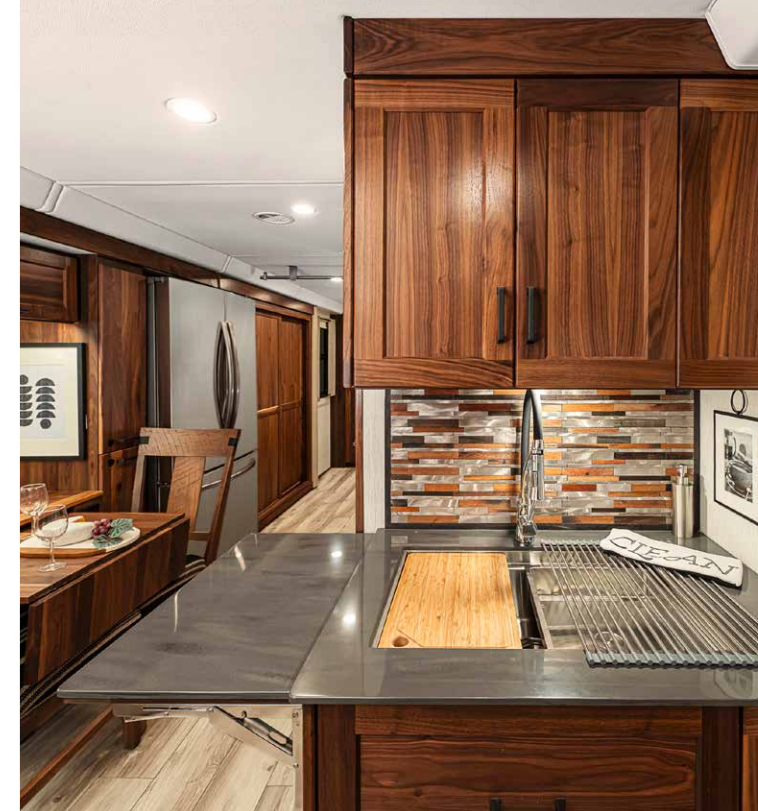





## Masterful Private Retreat

Just past the sliding privacy door with stainless barn style hardware, the slideout-equipped master bedroom is a spacious retreat. This polished master suite also includes smart storage solutions throughout the space.

- » Walkaround king bed with Easy Make™ bed system, power incline headrest and lockable under-bed storage compartment
- » 40" Smart HDTV
- » Baldacci® customizable Italian wardrobe system
- » Nightstands with medical device storage, 110V outlets and USB ports
- » Additional cabinets are prepped for the optional washer/dryer
- » Large shower (30" x 42") with integrated seat
- » Luxury dual shower heads with large rainfall shower feature and wand fixture
- » Electric-flush porcelain toilet







## High End Driving Experience







The Journey's new front end design maximizes visibility and minimizes noise, while the Freightliner DriveTech™ driving system provides the most advanced display and control system in the RV industry.

- » Ergonomic steering wheel featuring a TRW® tilt/telescopic steering column with foot-actuated pedal
- » DriveTech™ column-mounted controls paired with the OptiView™ all-digital dash and instrument panel cluster
- » Six-way power-assisted driver and passenger seats with swivel function, adjustable armrests, multi-adjustable recline, and fixed lumbar support
- » Xite® Radio 12.3" LCD color touch screen, Infotainment/GPS navigation system, radio/rearview monitor system, handheld remote, rear color camera, Sirius-XM®-ready, USB input
- » HDMI and MHL connectivity with CB wiring prep



## Winnebago Connect

Our new Winnebago Connect™ smart coach system allows you to control all aspects of your coach from your mobile device. In addition to the mobile interface, the Winnebago Connect control panel is located in the hallway next to the bedroom.

-  **Home** - monitor tank resources, climate, battery level and more
-  **Power** - check AC power, energy management, generator status
-  **Temperature** - adjust heating and air anywhere in the motorhome
-  **Lighting** - control lights inside or outside the coach
-  **Slideout, awning and leveling** - settle in and expand your living space or retract for travel
-  **Settings** - personalize your Winnebago Connect system to your preferences





# Journey

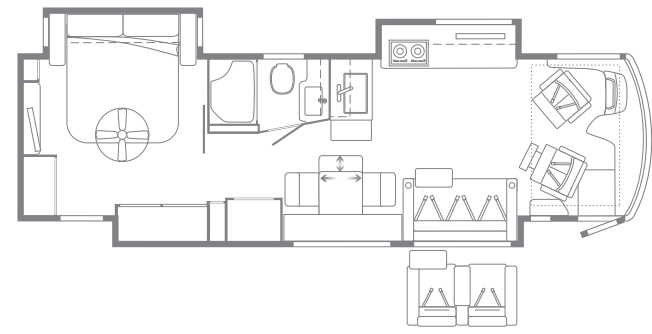

**34N**

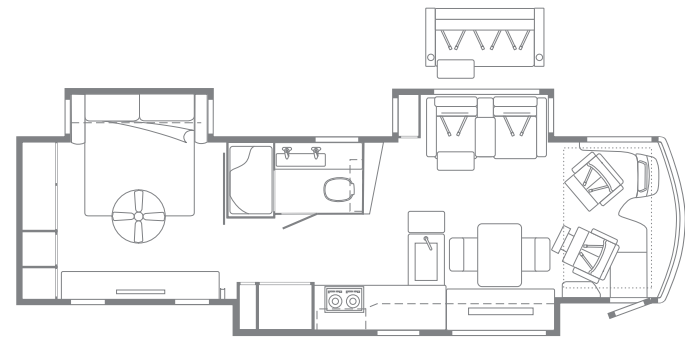

**36K**

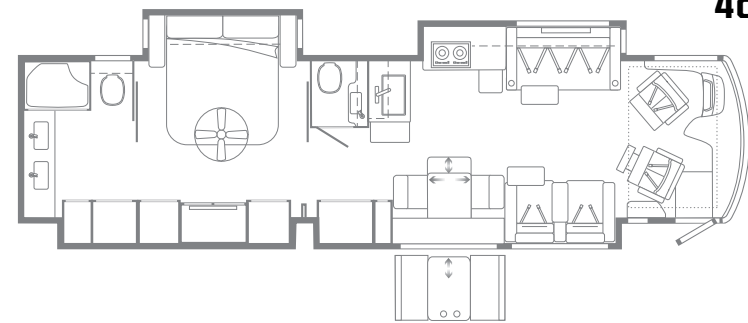

**40P**

WEIGHTS   MEASURES	<b>34N</b>	<b>36K</b>	<b>40P</b>
<b>Length</b>	35'6"	37'9"	41'4"
<b>Exterior Height<sup>1</sup></b>	13'3"	13'3"	13'3"
<b>Exterior Width<sup>2</sup></b>	8'5.5"	8'5.5"	8'5.5"
<b>Exterior Storage<sup>3</sup></b> (cu. ft.)	138	187	256
<b>Awning Length</b>	22'	22'	22'
<b>Interior Height</b>	7'0"	7'0"	7'0"
<b>Interior Width</b>	8'0.5"	8'0.5"	8'0.5"
<b>Freshwater Tank Capacity<sup>4</sup></b> (gal.)	105	105	105
<b>Water Heater Capacity</b> (gal.)	Continuous	Continuous	Continuous
<b>Holding Tank Capacity-Black/Gray<sup>4</sup></b> (gal.)	57/96	57/96	57/96
<b>LP Capacity<sup>5</sup></b> (lbs.)	N/A	N/A	N/A
<b>Fuel Capacity</b> (gal.)	100	100	100
<b>GCWR<sup>6</sup></b> (lbs.)	46,400	48,700	48,700
<b>GVWR</b> (lbs.)	36,400	38,700	38,700
<b>GAWR - Front</b> (lbs.)	12,400	14,700	14,700
<b>GAWR - Rear</b> (lbs.)	24,000	24,000	24,000
<b>Wheelbase</b>	205"	232"	275"



**FOOTNOTES**

- The height of each model is measured to the top of the tallest standard feature and is based on the curb weight of a typically equipped unit. The actual height of your vehicle may vary by several inches depending on chassis or equipment variations. Contact your dealer for further information.
  - Floorplans feature a wide-body design - over 96". You should be aware that some states restrict access on some or all state roads to 96" in body width. You should confirm the road usage laws in the states of interest to you.
  - The load capacity of your motorhome is designated by weight, not by volume, so you cannot necessarily use all available space when loading your motorhome.
  - Capacities are based on measurements prior to tank installation. Slight capacity variations can result.
  - Capacities shown are the tank manufacturer's listed water capacity (W.C.). Actual filled propane capacity is 80% of listing due to overfilling prevention device on tank.
  - Actual towing capacity is dependent on your particular loading and towing circumstances which includes the GVWR, GAWR, and GCWR as well as adequate trailer brakes. Refer to the chassis operator's manual of your motorhome for further towing information.
- Not all items available in combination. See dealer for details.

## DÉCOR

### HEWING

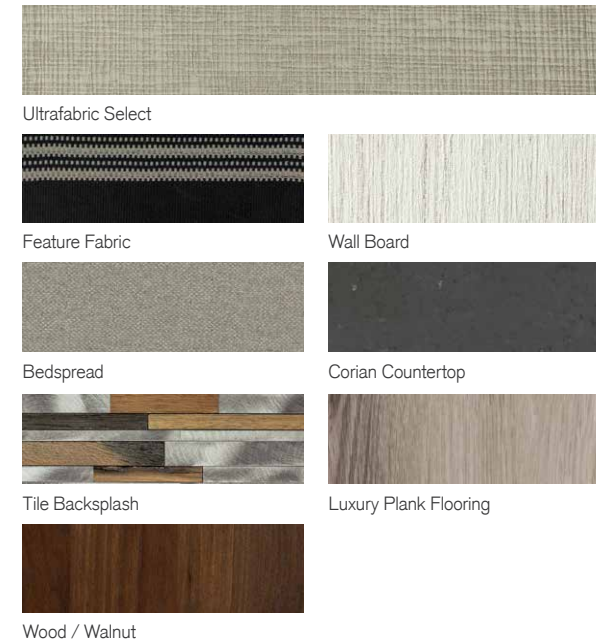

Wood / Walnut



**MOJAVE DUSK**



**BLACK CHERRY**

### LAUREL

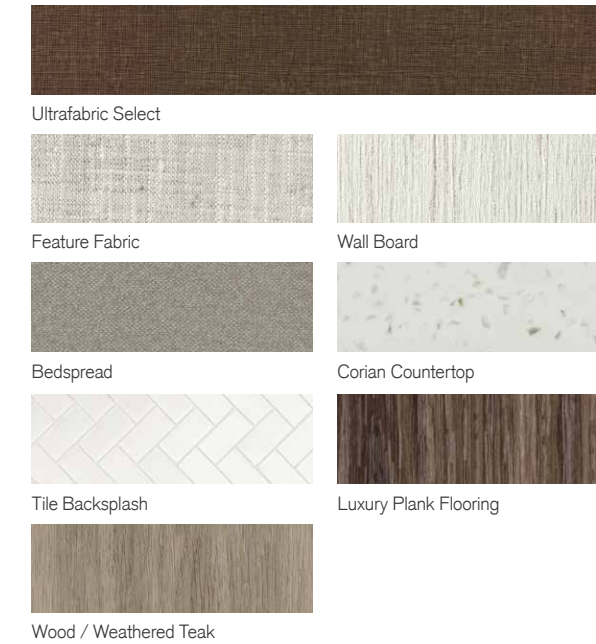

Wood / Weathered Teak



**AUTUMN SAGE**



**MIDNIGHT**

### AMERICANA

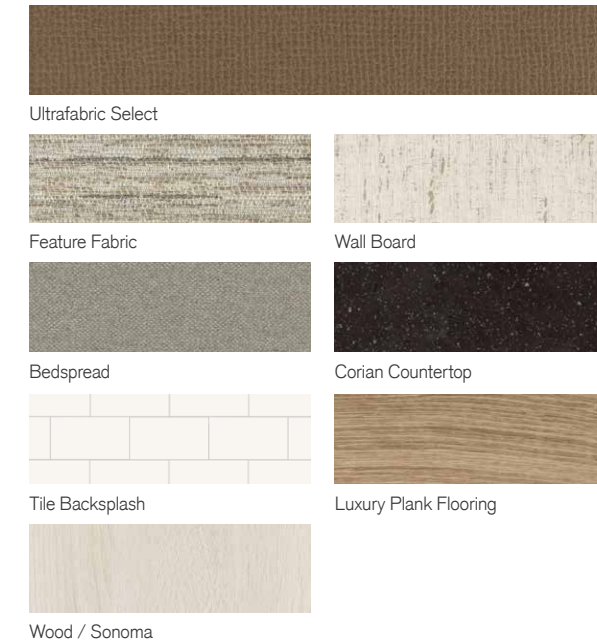

Wood / Sonoma



**STEEL GREY**



**SUNLIT**

**i Visit Winnebago.com for more info**

**+ Join a boundless community of adventurers in the Owners Section of Winnebago.com**

**f Connect with other Journey owners on the Winnebago Journey Owners Group Facebook group.**

©2020 Winnebago Printed in USA 11/20

Because features, specifications, equipment, and options may vary from those highlighted in this brochure, the buyer is responsible for confirming with the dealer the features, specifications, equipment, and options included on their specific vehicle. In addition, Winnebago's program of continuous product improvement may result in changes to vehicle specifications, equipment, model availability, and price without notice.



QUALITY

INNOVATION

SERVICE

***WINNEBAGO***

